

# ULR LANDSCAPE RAKES

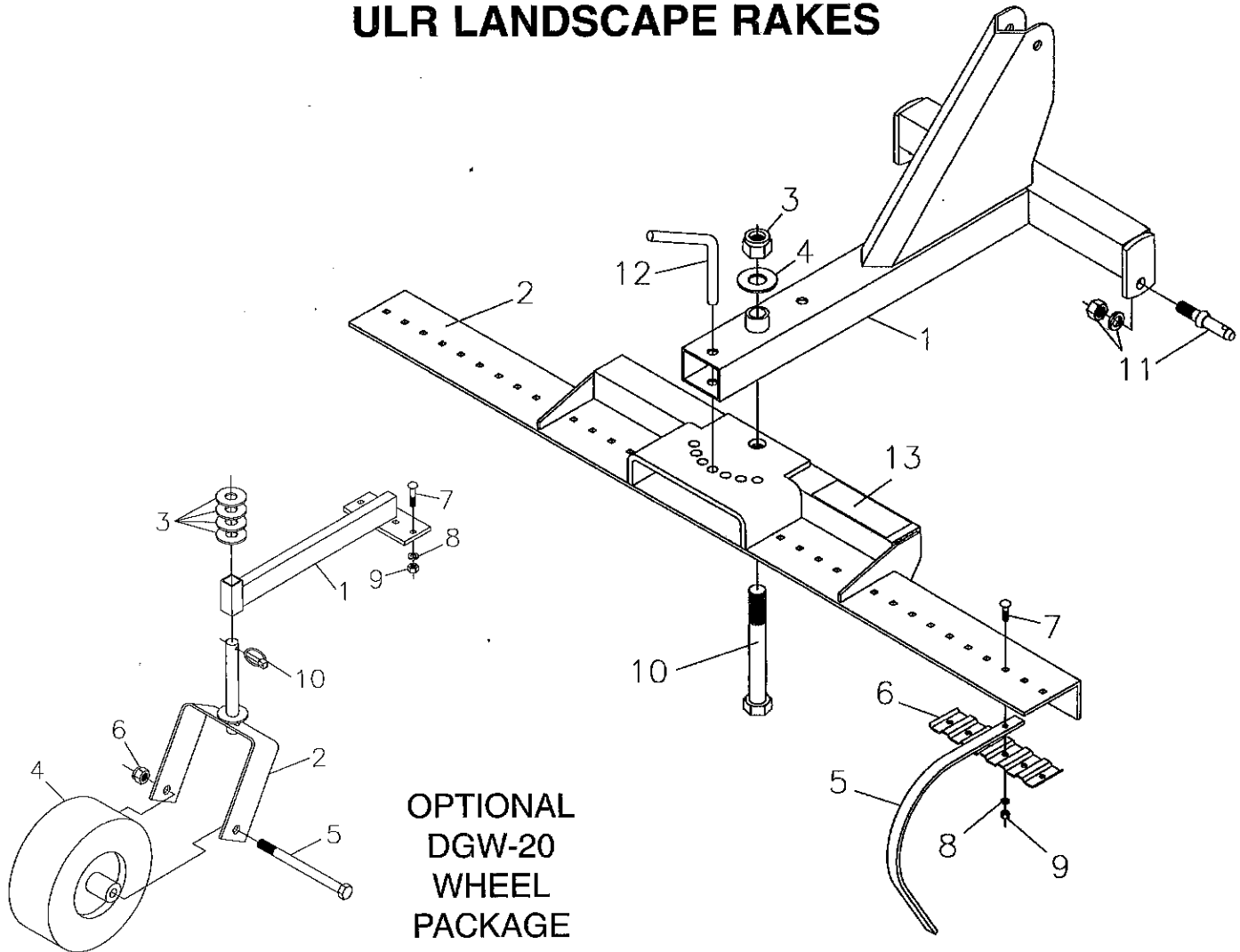

**OPTIONAL  
DGW-20  
WHEEL  
PACKAGE**

| REF. NO. | PART NO. | DESCRIPTION                                 | NO. REQ. |
|----------|----------|---|----------|
| 1        | 341860   | 3 Pt. Mount Frame                           | 1        |
| 2        | 341736   | Tinebar Weldment - 6 ft.                    | 1        |
| NS       | 341742   | Tinebar Weldment - 7 ft.                    | 1        |
| NS       | 341751   | Tinebar Weldment - 8 ft.                    | 1        |
| 3        | 2500053  | Nut 1 1/4" - 7 NC Nylock Hex                | 1        |
| 4        | 2501010  | Flatwasher 1 1/4"                           | 1        |
| 5        | 341704   | Rake Tooth - 6 ft.                          | 36       |
|          |          | Rake Tooth - 7 ft.                          | 42       |
|          |          | Rake Tooth - 8 ft.                          | 48       |
| 6        | 341705   | Tooth Support - 6 ft.                       | 6        |
|          |          | Tooth Support - 7 ft.                       | 7        |
|          |          | Tooth Support - 8 ft.                       | 8        |
| 7        | 2503103  | Carriage Bolt 3/8" - 16 NC x 1 1/2" - 6 ft. | 36       |
|          |          | Carriage Bolt 3/8" - 16 NC x 1 1/2" - 7 ft. | 42       |
|          |          | Carriage Bolt 3/8" - 16 NC x 1 1/2" - 8 ft. | 48       |
| 8        | 2502008  | Lockwasher 3/8" Spring - 6 ft.              | 36       |
|          |          | Lockwasher 3/8" Spring - 7 ft.              | 42       |
|          |          | Lockwasher 3/8" Spring - 8 ft.              | 48       |
| 9        | 2500004  | Nut 3/8" - 16 NC Full Hex - 6 ft.           | 36       |
|          |          | Nut 3/8" - 16 NC Full Hex - 7 ft.           | 42       |
|          |          | Nut 3/8" - 16 NC Full Hex - 8 ft.           | 48       |
| 10       | 2503261  | Bolt 1 1/4" - 7 NC x 10" Hex Head Gr. 5     | 1        |

| REF. NO. | PART NO. | DESCRIPTION             | NO. REQ. |
|----------|----------|-------------------------|----------|
| 11       | 590108   | Cat. I Drawpin (AK-578) | 2        |
| 12       | 350030   | Adjustment Pin          | 1        |
| 13       | 101148   | Decal - Caution         | 1        |

## DGW-20 WHEEL PACKAGE (OPTIONAL)

| REF. NO. | PART NO. | DESCRIPTION                          | NO. REQ. |
|----------|----------|--------------------------------------|----------|
| 1        | 341778   | Wheel Support Arm                    | 2        |
| 2        | 341779   | Wheel Mount                          | 2        |
| 3        | 2501001  | Washer 1" Flat                       | 44       |
| 4        | 341772   | Wheel Assembly (13.00 x 5.00)        | 2        |
| 5        | 2503188  | Bolt 3/4" - 10 NC x 9 1/2" Hex Head  | 2        |
| 6        | 2500037  | Nut 3/4" - 10 NC Hex Nylock          | 2        |
| 7        | 2503189  | Bolt 3/8" - 16 NC x 2" Carriage Head | 8        |
| 8        | 2502008  | Washer 3/8" Springlock               | 8        |
| 9        | 2500004  | Nut 3/8" - 16 NC Full Hex            | 8        |
| 10       | 590034   | Linch pin 1/4" (AK-61)               | 2        |